

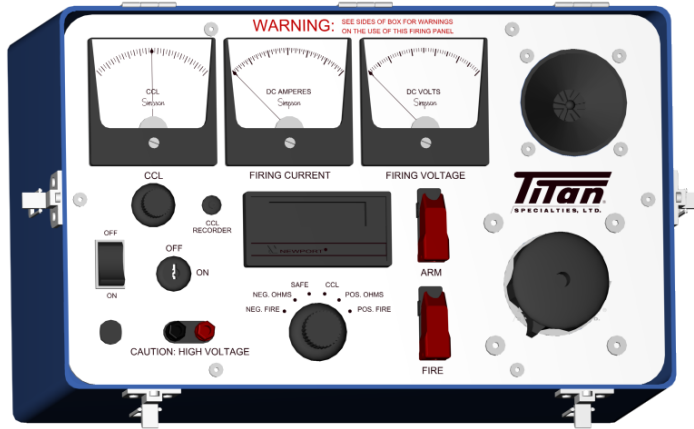

## SPECIFICATIONS

<p><u>MODEL NUMBER</u> <i>PORTABLE</i></p> <p><b>9001-000-000</b></p>
<p><u>MODEL NUMBER</u> <i>RACK MOUNT</i></p> <p><b>9001-000-100</b></p>
<p><u>SPECIAL FEATURES</u></p> <p><b>Stainless Steel Face</b></p> <p><b>Digital Ohmmeter</b></p> <p><b>Sensitive CCL Meter</b></p> <p><b>Amplified CCL</b></p> <p><b>Audible Cap Fire Indicator</b></p> <p><b>Safety Key Operation</b></p> <p><b>Handles on Rack Mount plus Steel Brackets &amp; Rubber Feet</b></p>
<p><u>OPERATING VOLTAGE</u></p> <p><b>120 VAC, 60 Hz</b></p>
<p><u>DIMENSIONS</u> <i>PORTABLE</i></p> <p><b>Height: 12.5" (31.8 cm)</b></p> <p><b>Width: 17" (43.2 cm)</b></p> <p><b>Depth: 11.5" (29.2 cm)</b></p> <p><b>Weight: 45 lbs (20.4 kg)</b></p>
<p><u>DIMENSIONS</u> <i>RACK MOUNT</i></p> <p><b>Height: 10.5" (26.7 cm)</b></p> <p><b>Width: 17" (43.2 cm)</b></p> <p><b>Depth: 13.0" (33.0 cm)</b></p> <p><b>Mount Standard 19" Rack</b></p>
<p><u>OHMMETER</u></p> <p><b>Range: 8,000 ohms</b></p> <p><b>Resolution: 1 ohm</b></p>
<p><u>OUTPUT</u></p> <p><b>Positive or Negative Voltage</b></p> <p><b>0 to 500 volts @ 2 amps</b></p>

PORTABLE  
TOP VIEW  
9001-000-000  
(SHOWN WITH LID REMOVED)



RACK MOUNT  
FRONT VIEW  
9001-000-100



**NOB-GZ-1000S-MD-1-10M-FMS**  
**BOX**